

# LESTERTOWN ROAD PUMP STATION SHED AND FENCE REPLACEMENT JULY 2015

PROJECT LOCATION  
285 LESTERTOWN  
ROAD

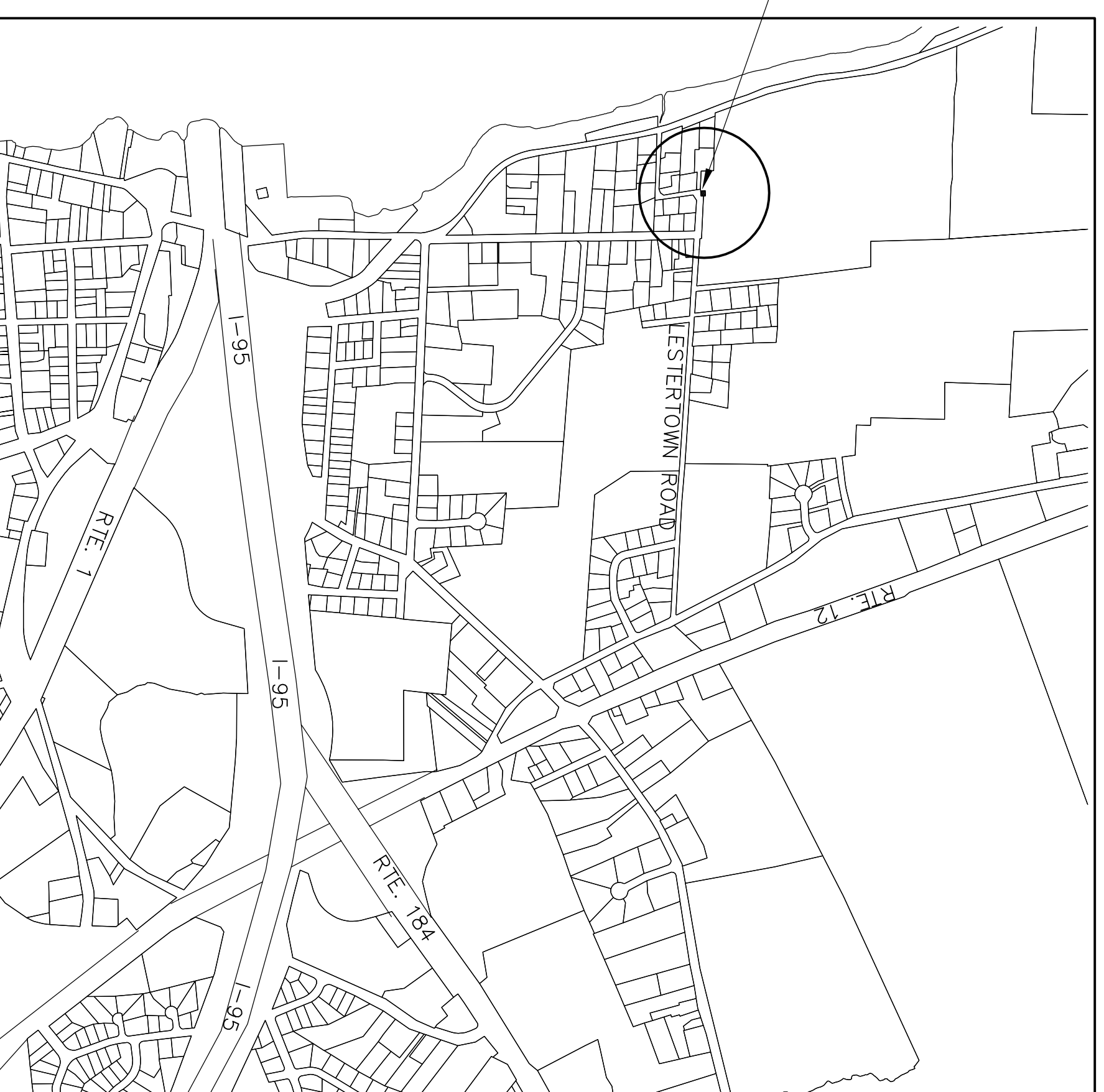

## PLAN INDEX

TITLE	PAGE
COVER SHEET	1
LAYOUT PLAN	2
SHED	3
FENCE & DETAILS	4

TOWN MANAGER

MARK R. OEFFINGER

DIRECTOR OF PUBLIC WORKS

GARY J. SCHNEIDER

ENGINEERS

TOWN OF GROTON

DEPARTMENT OF PUBLIC WORKS