

V:\1951\active\192310492 - DOT-MDC Water Main Survey\West St Boring Plan.dwg
 2016/05/25 4:04 PM By: Bartowski, Vanessa

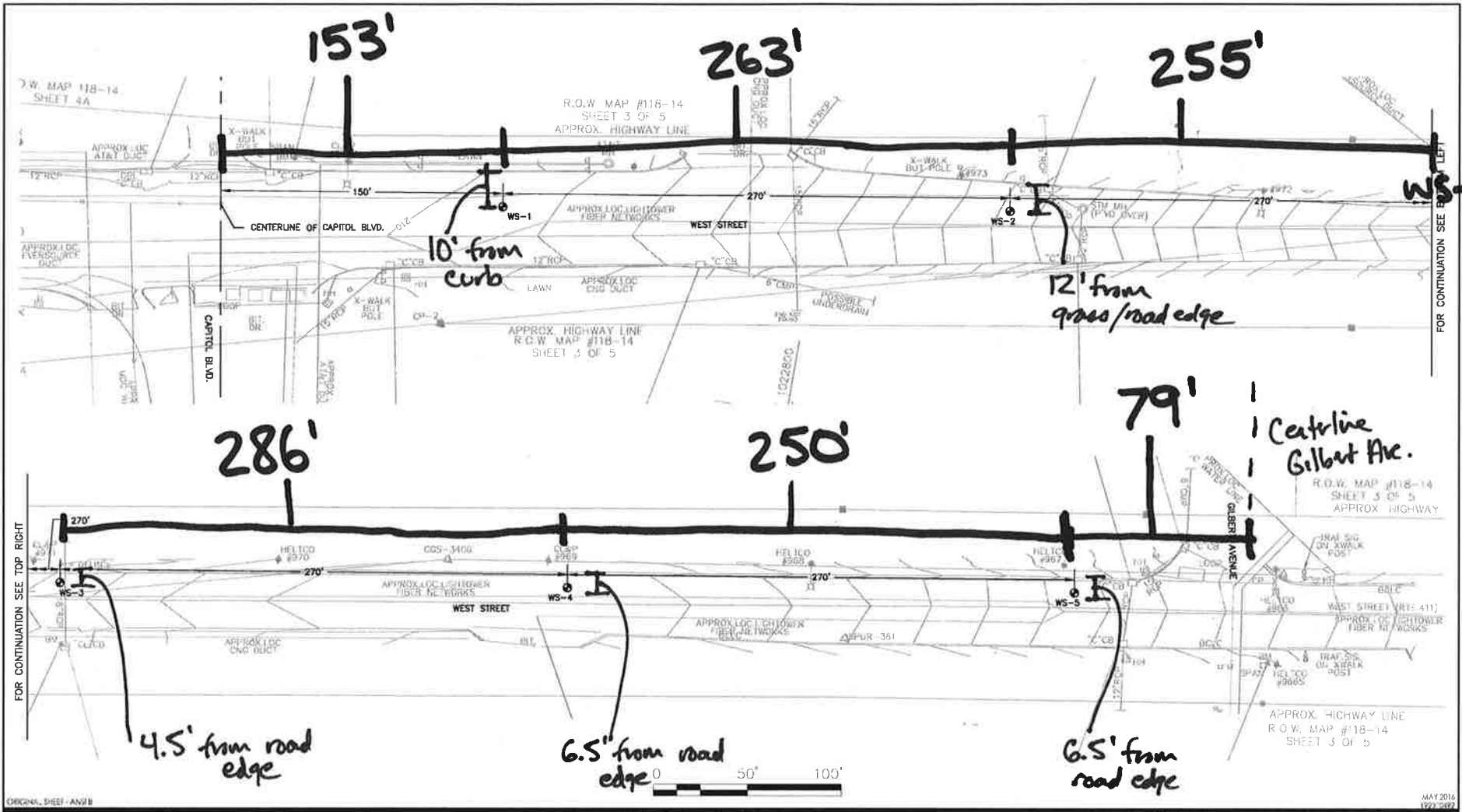

Stantec Consulting Services Inc.
 55 Church Street, Suite 601
 New Haven, CT 06510-3014
 www.stantec.com

Legend
 ● WS-# BORING LOCATION

Notes

Client/Project
 CIDOT
 ROUTE 160 OVER I-91
 ROCKY HILL, CT
 Figure No.
 6
 Title
 PROPOSED BORING LOCATION PLAN
 WEST ST AND CAPITOL BLVD WATER MAIN

CLIENT Connecticut Department of Transportation
 LOCATION West Street, Rocky Hill, CT
 EXPLORATION DATE 9/16/2016 to 9/16/2016 WATER LEVEL NE

PROJECT No. 192310492
 EXPLORATION No. WS-1
 DATUM _____

DEPTH (ft)	ELEVATION (ft)	MATERIAL DESCRIPTION	STRATA PLOT	WATER LEVEL	SAMPLES					PID Reading (PPM)	Undrained Shear Strength - tsf							
					TYPE	NUMBER	RECOVERY	SPT blows / 6"	SPT N-Value		1	2	3	4				
0		8 inches of ASPHALT pavement																
		Brown, c-f SAND, some m-f gravel, trace silt.				SS	S-1	8	17 29 35 45	64	0.0							
		Brown, c-f SAND, some m-f gravel, little silt. -GLACIAL TILL-				SS	S-2	15	24 14 11 22	35	0.1							
5		Brown, c-f SAND, some m-f gravel, little silt.				SS	S-3	15	19 23 21 19	44	0.2							
		Brown, f SAND and silt, some m-f gravel.				SS	S-4	12	33 35 45 65	80	0.0							
10		End of boring at 9 feet below ground surface. No refusal.																
15																		
20																		

Driller: Trent Roe; Supervisor: Matt Kenney (Stantec)
 Mobil B-53, Truck Rig, 2.25 inch HSA
 Hammer Type: 140# Safety Hammer, free falling 30 inches

- △ Unconfined Compression Test
- Field Vane Test ■ Remolded
- ✕ Pocket Penetrometer / Torvane

CLIENT Connecticut Department of Transportation
 LOCATION West Street, Rocky Hill, CT
 EXPLORATION DATE 9/16/2016 to 9/16/2016 WATER LEVEL NE

PROJECT No. 192310492
 EXPLORATION No. WS-2
 DATUM _____

DEPTH (ft)	ELEVATION (ft)	MATERIAL DESCRIPTION	STRATA PLOT	WATER LEVEL	SAMPLES					PID Reading (PPM)	Undrained Shear Strength - tsf							
					TYPE	NUMBER	RECOVERY	SPT blows / 6"	SPT N-Value		1	2	3	4				
0		8 inches of ASPHALT pavement					in.											
		Brown, m-f SAND, little m-f gravel, little silt.				SS	1	13	10 10 12 7	22	0.0							
		Brown, f SAND and silt, trace f gravel. -GLACIAL TILL-				SS	2	15	10 11 15 21	26	0.0							
5		Brown, f SAND and silt, trace f gravel.				SS	3	16	19 22 28 40	50	0.0							
		Brown, f SAND and silt, some m-f gravel.				SS	4	13	22 52 46 44	98	0.0							>>
10		End of boring at 9 feet below ground surface. No refusal.																
15																		
20																		

Driller: Trent Roe; Supervisor: Matt Kenney (Stantec)
 Mobil B-53, Truck Rig, 2.25 inch HSA
 Hammer Type: 140# Safety Hammer, free falling 30 inches

- △ Unconfined Compression Test
- Field Vane Test ■ Remolded
- ✕ Pocket Penetrometer / Torvane

CLIENT Connecticut Department of Transportation
 LOCATION West Street, Rocky Hill, CT
 EXPLORATION DATE 9/16/2016 to 9/16/2016 WATER LEVEL NE

PROJECT No. 192310492
 EXPLORATION No. WS-3
 DATUM _____

DEPTH (ft)	ELEVATION (ft)	MATERIAL DESCRIPTION	STRATA PLOT	WATER LEVEL	SAMPLES					PID Reading (PPM)	Undrained Shear Strength - tsf							
					TYPE	NUMBER	RECOVERY	SPT blows / 6"	SPT N-Value		1	2	3	4				
0		8 inches of ASPHALT pavement					in.											
		Brown, f SAND and silt, little f gravel.				SS	1	7	12 16 17 20	33	0.0							
		Brown, SILT, little f sand, trace f gravel. -GLACIAL TILL-				SS	2	14	3 4 5 10	9	0.0							
5		Brown, SILT, trace m-f gravel				SS	3	17	12 15 23 18	38	0.0							
		Brown, f SAND and silt, little m-f gravel.				SS	4	12	22 32 40 44	72	0.0							
10		End of boring at 9 feet below ground surface. No refusal.																
15																		
20																		

Driller: Trent Roe; Supervisor: Matt Kenney (Stantec)
 Mobil B-53, Truck Rig, 2.25 inch HSA
 Hammer Type: 140# Safety Hammer, free falling 30 inches

- △ Unconfined Compression Test
- Field Vane Test ■ Remolded
- ✕ Pocket Penetrometer / Torvane

CLIENT Connecticut Department of Transportation
 LOCATION West Street, Rocky Hill, CT
 EXPLORATION DATE 9/16/2016 to 9/16/2016 WATER LEVEL NE

PROJECT No. 192310492
 EXPLORATION No. WS-4
 DATUM _____

DEPTH (ft)	ELEVATION (ft)	MATERIAL DESCRIPTION	STRATA PLOT	WATER LEVEL	SAMPLES					PID Reading (PPM)	Undrained Shear Strength - tsf						
					TYPE	NUMBER	RECOVERY	SPT blows / 6"	SPT N-Value		1	2	3	4			
0		8 inches of ASPHALT pavement					in.										
		Brown, f SAND and silt, some m-f gravel.				SS	1	9	11 13 15 16	28	0.0						
		Brown, f SAND and silt, some m-f gravel. -GLACIAL TILL-				SS	2	15	16 16 23 23	39	0.0						
5		Brown, SILT, little m-f gravel, trace f sand. Rock fragments from 5.5 to 5.75 feet.				SS	3	9	75 100/3"	R	0.0						
		Brown, f SAND and silt, little m-f gravel.				SS	4	18	14 15 17 23	32	0.0						
10		End of boring at 10 feet below ground surface. No refusal.															
15																	
20																	

Driller: Trent Roe; Supervisor: Matt Kenney (Stantec)
 Mobil B-53, Truck Rig, 2.25 inch HSA
 Hammer Type: 140# Safety Hammer, free falling 30 inches

- △ Unconfined Compression Test
- Field Vane Test ■ Remolded
- ✕ Pocket Penetrometer / Torvane

CLIENT Connecticut Department of Transportation
 LOCATION West Street, Rocky Hill, CT
 EXPLORATION DATE 9/16/2016 to 9/16/2016 WATER LEVEL NE

PROJECT No. 192310492
 EXPLORATION No. WS-5
 DATUM _____

DEPTH (ft)	ELEVATION (ft)	MATERIAL DESCRIPTION	STRATA PLOT	WATER LEVEL	SAMPLES					PID Reading (PPM)	Undrained Shear Strength - tsf							
					TYPE	NUMBER	RECOVERY	SPT blows / 6"	SPT N-Value		1	2	3	4				
0		8 inches of ASPHALT pavement					in.											
		Brown, f SAND and silt, some f gravel.				SS	S-1	11	20 21 27 28	48	0.0							
		Brown, SILT and f sand, little f gravel. -GLACIAL TILL-				SS	S-2	10	12 16 16 19	32	0.0							
5		Brown, f SAND and silt, little f gravel.				SS	S-3	4	100/4"	R	0.2							
		Brown, f SAND and silt, some f gravel.				SS	S-4	13	23 29 35 44	64	0.0							
10		End of boring at 10 feet below ground surface. No refusal.																
15																		
20																		

Driller: Trent Roe; Supervisor: Matt Kenney (Stantec)
 Mobil B-53, Truck Rig, 2.25 inch HSA
 Hammer Type: 140# Safety Hammer, free falling 30 inches

△ Unconfined Compression Test
 □ Field Vane Test ■ Remolded
 ✕ Pocket Penetrometer / Torvane